



EN & ENL



## EN & ENL Series

VALVE REGULATED LEAD-ACID BATTERIES

EN & ENL

# EN & ENL ENDURANCE VRLA BATTERIES

Suitable for all standby applications including Telecommunications, UPS, Emergency Lighting. Endurance range Batteries from Yuasa are the engineer's choice for even the most critical standby applications, available in 10 year (EN) and 15 year (ENL) models.

## FEATURES

- Long Life in standby (10 and 15 year design life options).
- Unique mix and match parallel assembly allows extensive variations to network capacity.
- Electrolyte Suspension. A.G.M. technology assures no free electrolyte to spill or worry about.
- High gas recombination efficiency. Eliminates the need for forced ventilation and separate battery rooms.
- Case Material Oxygen index 30.
- Fully compliant with BS6290-4 and IEC896-2.

## Terminal

8mm Stud or Female Internal Thread

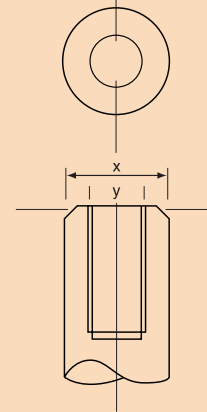

## Internal Type

x	y
20mm	M8

## Layout

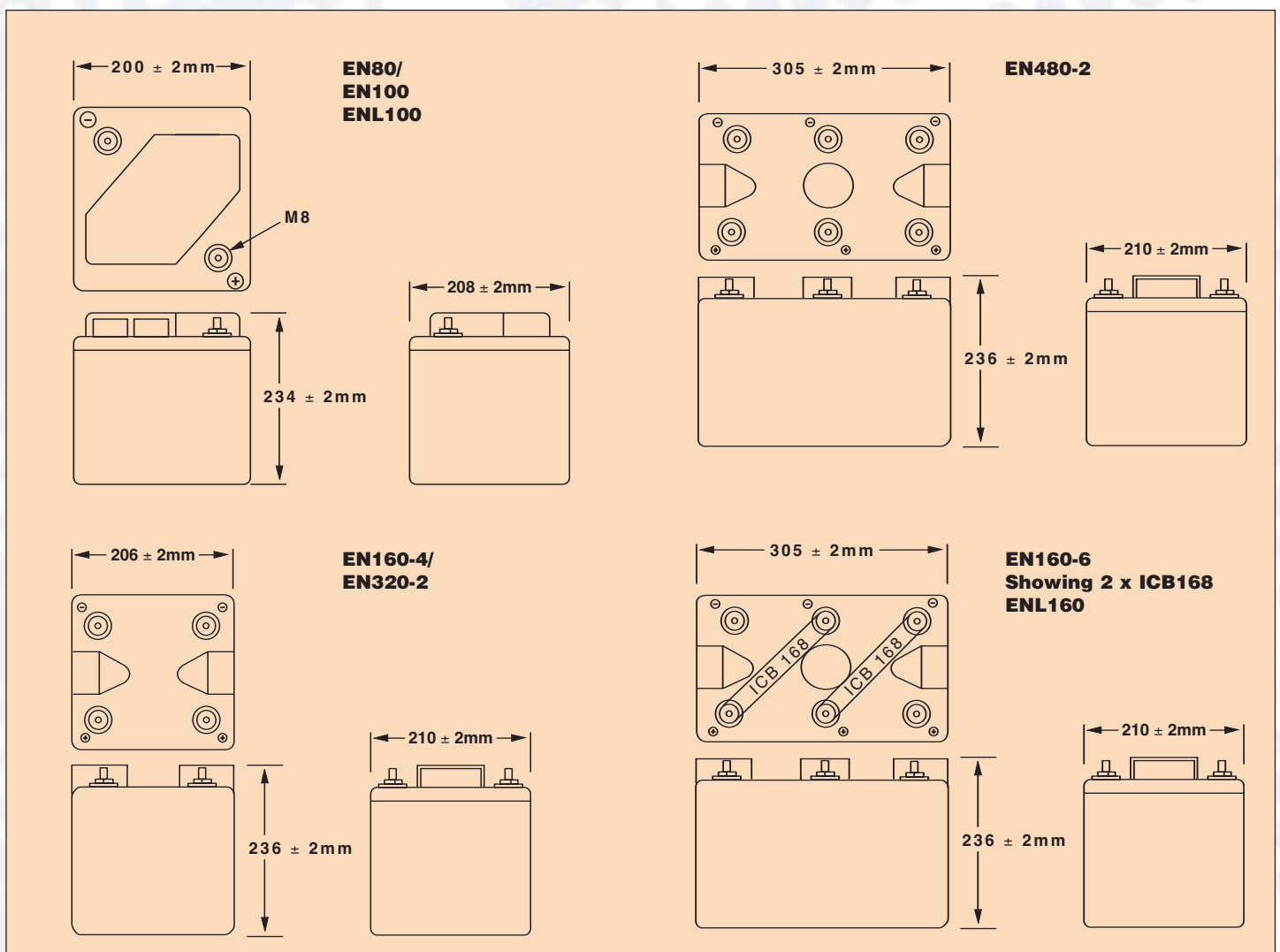

# General Specifications

Nominal Capacity (Ah)	EN80-6	EN80-4	EN100-6	ENL100-6	EN100-4	EN160-6	ENL160-6	EN160-4	EN320-2	EN480-2
10hr to 1.85vpc	80	80	100	100	100	160	160	160	320	480
3hr to 1.80vpc	65	65	81	81	81	129	129	129	258	387
1 hr to 1.75vpc	53	53	66	66	66	105	105	105	210	315
Voltage	6	4	6	6	4	6	6	4	2	2
Energy Density (Wh/L)	49	33	62	69	41	63	63	63	63	63
Specific Energy (Wh. kg)	20.8	18	26	26	26	23	27	27	27	27
Int Resistance (m.ohms)	1.8	1.2	1.8	1.8	1.2	1.2	1.2	0.8	0.3	0.2
Maximum discharge (A)	480	480	600	600	600	960	960	960	1920	2880
Short Circuit current	800	800	1000	1000	1000	1500	1500	1500	3000	4500
<b>Dimensions (mm)</b>										
Length	200	200	200	200	200	305	305	206	206	205
Width	208	208	208	208	208	210	210	210	210	210
Height overall	238	238	238	238	238	240	240	240	240	240
Weight (kg)	23	17.5	23	23	17.5	35	35	24	24	35
Terminal	< 8mm Male Stud >					< Female Insert >				
Terminal Torque (Nm)	6.1	6.1	6.1	6.1	6.1	6.1	6.1	6.1	6.1	6.1

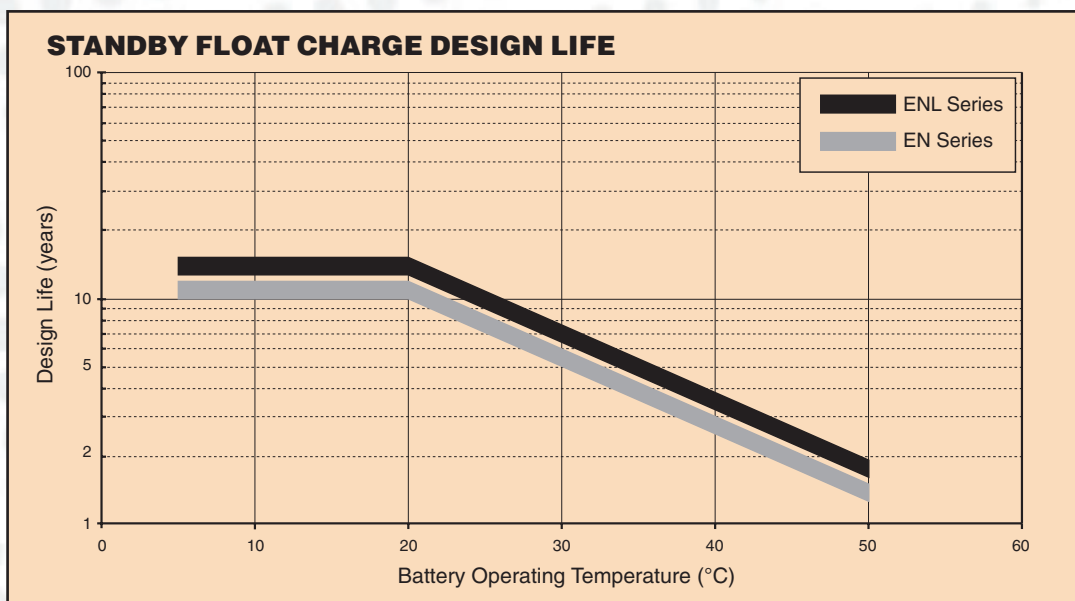
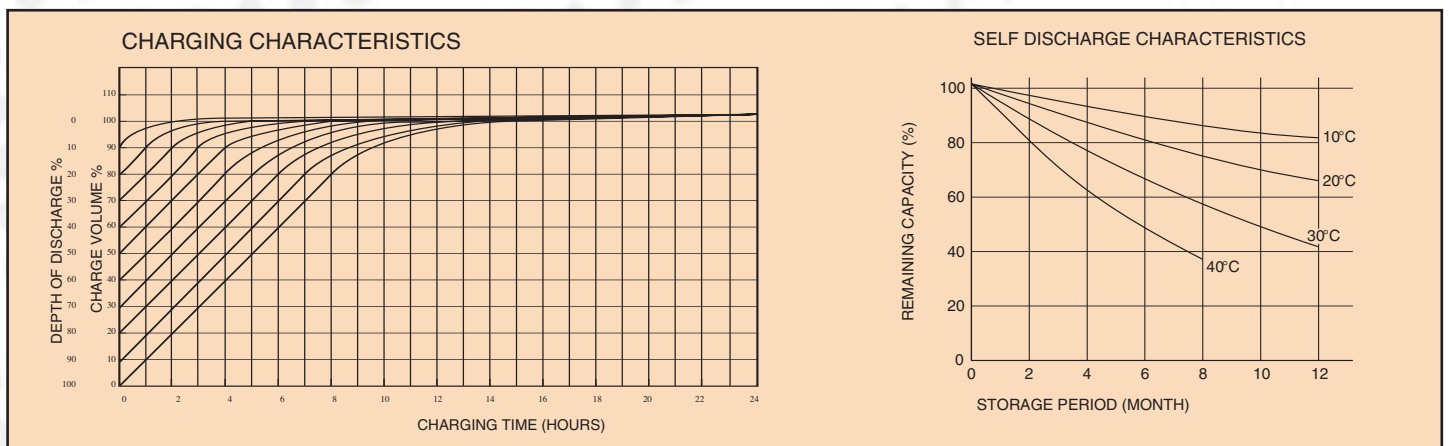

## Charging Methods (at 20°C)

Standby use: Float charging voltage 2.26v ± 0.005v

## CAUTION

- Avoid short circuit.
- Do not charge in a sealed container.

## DISCHARGE CHARACTERISTIC CURVES

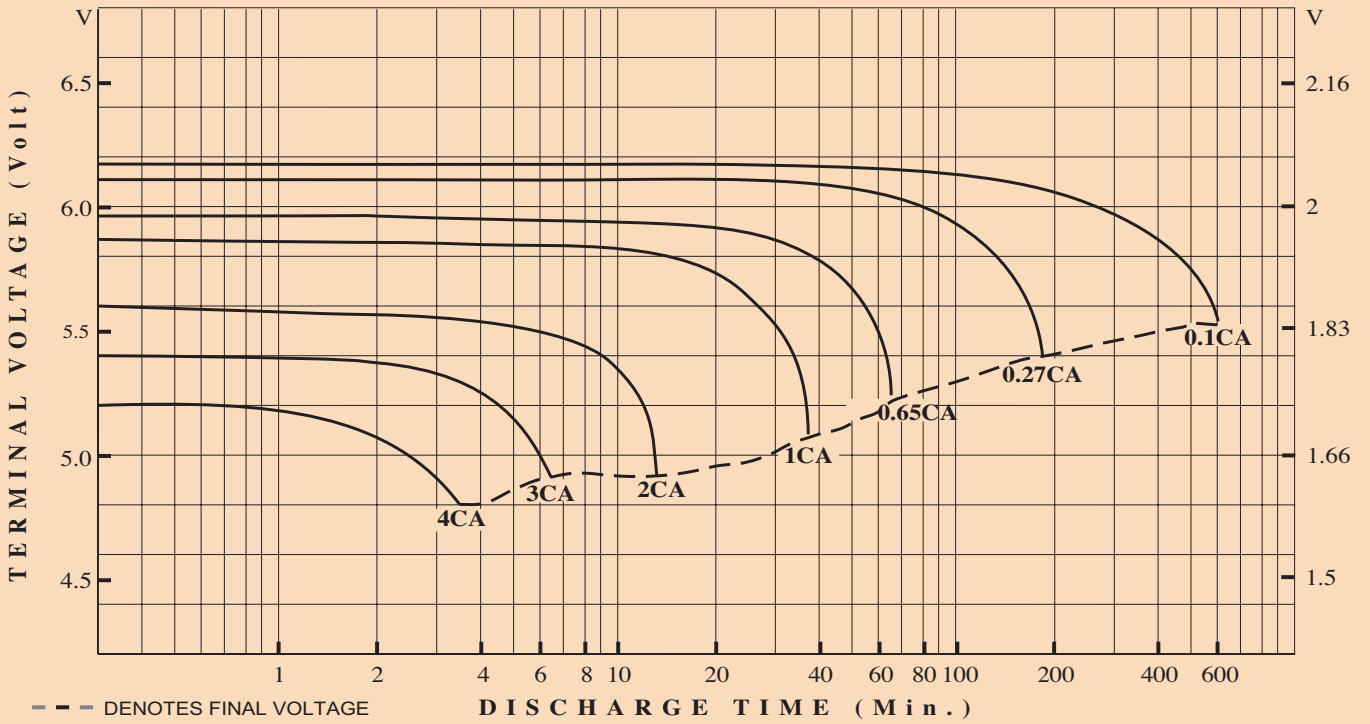

## CHARGING CHARACTERISTIC

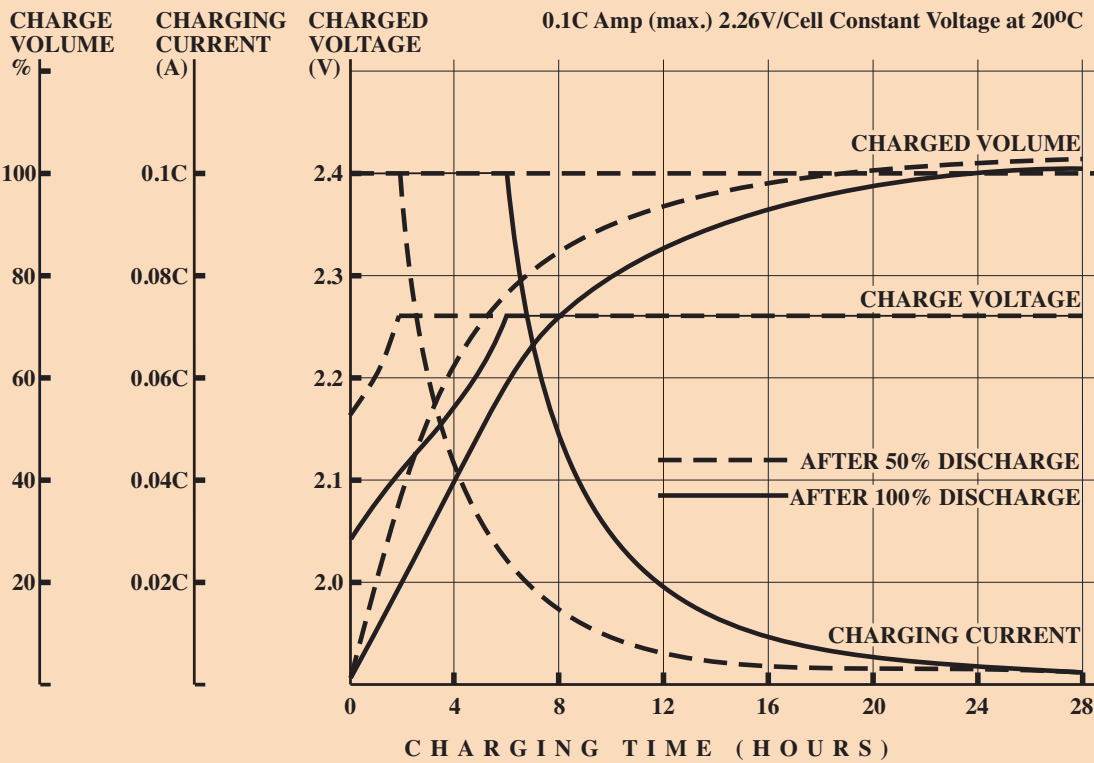

### Yuasa Battery Sales (UK) Ltd

Unit 22 Rassau Industrial Estate  
 Ebbw Vale, Gwent, NP23 5SD  
 Tel: 08708 500312 Fax: 08708 500317  
 E-mail: enquiries@yuasa-sales.co.uk

Registered number 1548820

Cat. No. EVRLASF April 06

E&O.E.

Distributed by